

U-229/U & U-329/U ASSEMBLY INSTRUCTIONS:

1. SLIDE STRAIN RELIEF SPRING (8) AND WIRE NUT (7) OVER WIRE (9).
2. PLACE METAL WASHER (6) AND RUBBER GROMMET (3) INTO WIRE COLLAR (5) AS SHOWN.
3. PLACE RUBBER WASHER (4) ON TOP OF PLASTIC COLLAR (10).
4. SLIDE BRAIDED SHIELD INTO GROOVE IN PLASTIC COLLAR (10) AND INSERT INTO CONNECTOR SHELL (1), ENSURING THAT SHIELD IS IN CONTACT WITH SHELL TO ENSURE PROPER GROUNDING.
5. PULL CABLE THROUGH WIRE NUT AND STRIP CABLE END AND SOLDER WIRES TO CONNECTOR BODY (2).
6. PLACE CABLE ASSEMBLY PLACE INTO OUTER SHELL (1), ENSURING KEYS LINE UP ALIGNMENT GROOVES IN CONNECTOR SHELL.
7. SCREW WIRE COLLAR (5) ONTO OUTER SHELL (1) AND WIRE NUT (7) ONTO WIRE COLLAR TO COMPLETE ASSEMBLY.
8. WIRE OUTSIDE DIAMETER OF .25" RECOMMENDED TO ENSURE THAT RUBBER GROMMET WILL COMPRESS ONTO WIRE JACKET TO CREATE A STRONG ATTACHMENT

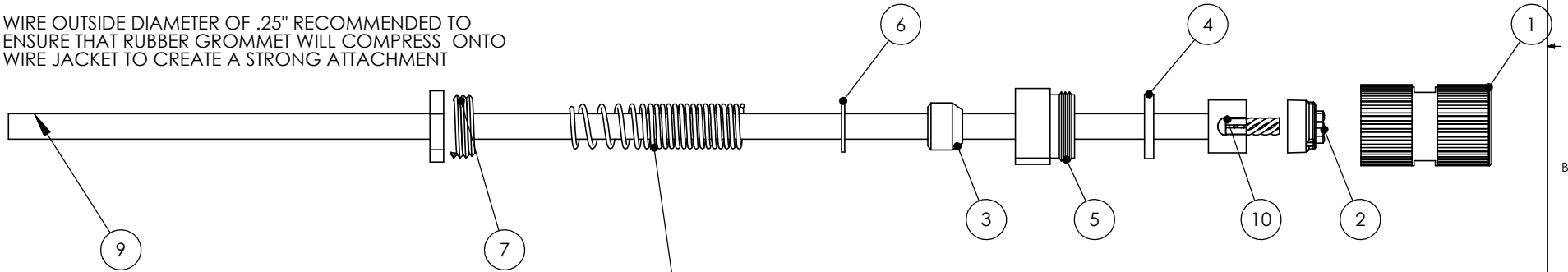

ITEM NO.	DESCRIPTION	QTY.
1	OUTER SHELL	1
2	CONNECTOR BODY	1
3	RUBBER GROMMET	1
4	RUBBER WASHER	1
5	WIRE COLLAR	1
6	METAL WASHER	1
7	WIRE NUT	1
8	STRAIN RELIEF SPRING	1
9	WIRE	1
10	PLASTIC BUSHING	1

UNLESS OTHERWISE SPECIFIED:		NAME	DATE	614 CORPORATE WAY SUITE 8M VALLEY COTTAGE, NY 10980 CAGE CODE: 1HJX9	
DIMENSIONS ARE IN: INCHES		DRAWN	DD	07/13/09	TITLE: U-229/U CONNECTOR ASSEMBLY INSTRUCTIONS
TOLERANCES: .XX: ± .01 .XXX: ± .005		CHECKED	RB	07/13/09	
ANGULAR: .X°: .XX°:		COMMENTS:			
INTERPRET GEOMETRIC TOLERANCING PER:		PROPRIETARY AND CONFIDENTIAL			SIZE B DWG. NO. U-229/U ASSY REV A SCALE: 1:2 WEIGHT: SHEET 1 OF 1
MATERIAL SEE ABOVE		THE INFORMATION CONTAINED IN THIS DRAWING IS THE SOLE PROPERTY OF <INSERT COMPANY NAME HERE>. ANY REPRODUCTION IN PART OR AS A WHOLE WITHOUT THE WRITTEN PERMISSION OF <INSERT COMPANY NAME HERE> IS PROHIBITED.			
FINISH N/A					
DO NOT SCALE DRAWING					

